

# FLANGE DIMENSIONS - DIN

DN	PN 6			
	D	n	Hcd	d
10	75	4	50	11
15	80	4	55	11
20	90	4	65	11
25	100	4	75	11
32	120	4	90	14
40	130	4	100	14
50	140	4	110	14
65	160	4	130	14
80	190	4	150	18
100	210	4	170	18
125	240	8	200	18
150	265	8	225	18
200	320	8	280	18
250	375	12	335	18
300	440	12	395	22
350	490	12	445	22
400	540	16	495	22
450	595	16	550	22
500	645	20	600	22
600	755	20	705	26

D = Flange diameter  
n = Number of bolt holes  
Hcd = Hole circle diameter  
d = Diameter of bolt holes

DN	PN 10			
	D	n	Hcd	d
10	90	4	60	14
15	95	4	65	14
20	105	4	75	14
25	115	4	85	14
32	140	4	100	18
40	150	4	110	18
50	165	4	125	18
65	185	4	145	18
80	200	8	160	18
100	220	8	180	18
125	250	8	210	18
150	285	8	240	22
200	340	8	295	22
250	395	12	350	22
300	445	12	400	22
350	505	16	460	22
400	565	16	515	26
450	615	20	565	26
500	670	20	620	26
600	780	20	725	30

D = Flange diameter  
n = Number of bolt holes  
Hcd = Hole circle diameter  
d = Diameter of bolt holes

## FLANGE DIMENSIONS - DIN

DN	PN 16			
	D	n	Hcd	d
10	90	4	60	14
15	95	4	65	14
20	105	4	75	14
25	115	4	85	14
32	140	4	100	18
40	150	4	110	18
50	165	4	125	18
65	185	4	145	18
80	200	8	160	18
100	220	8	180	18
125	250	8	210	18
150	285	8	240	22
200	340	12	295	22
250	405	12	355	26
300	460	12	410	26
350	520	16	470	26
400	580	16	525	30
450	640	20	585	30
500	715	20	650	33
600	840	20	770	36

D = Flange diameter  
n = Number of bolt holes  
Hcd = Hole circle diameter  
d = Diameter of bolt holes

DN	PN 25			
	D	n	Hcd	d
10	90	4	60	14
15	95	4	65	14
20	105	4	75	14
25	115	4	85	14
32	140	4	100	18
40	150	4	110	18
50	165	4	125	18
65	185	8	145	18
80	200	8	160	18
100	235	8	190	22
125	270	8	220	26
150	300	8	250	26
200	360	12	310	26
250	425	12	370	30
300	485	16	430	30
350	555	16	490	33
400	620	16	550	36
450	670	20	600	36
500	730	20	660	36
600	845	20	770	39

D = Flange diameter  
n = Number of bolt holes  
Hcd = Hole circle diameter  
d = Diameter of bolt holes

# FLANGE DIMENSIONS - DIN

DN	PN 40			
	D	n	Hcd	d
10	90	4	60	14
15	95	4	65	14
20	105	4	75	14
25	115	4	85	14
32	140	4	100	18
40	150	4	110	18
50	165	4	125	18
65	185	8	145	18
80	200	8	160	18
100	235	8	190	22
125	270	8	220	26
150	300	8	250	26
200	375	12	320	30
250	450	12	385	33
300	515	16	450	33
350	580	16	510	36
400	660	16	585	39
450	685	20	610	39
500	755	20	670	42
600	890	20	795	48

D = Flange diameter

n = Number of bolt holes

Hcd = Hole circle diameter

d = Diameter of bolt holes

# FLANGE DIMENSIONS - JIS

DN	INCH	JIS 5K						JIS 10K						JIS 16K						JIS 20K						
		D	Hcd	d	BOLT	n	mm	D	Hcd	d	BOLT	n	mm	D	Hcd	d	BOLT	n	mm	D	Hcd	d	BOLT	n	mm	
15	1/2	80	60	12	M10	4	95	70	15	M12	4	95	70	15	M12	4	95	70	15	M12	4	95	70	15	M12	4
20	3/4	85	65	12	M10	4	100	75	15	M12	4	100	75	15	M12	4	100	75	15	M12	4	100	75	15	M12	4
25	1	95	75	12	M10	4	125	90	19	M16	4	125	90	19	M16	4	125	90	19	M16	4	125	90	19	M16	4
32	1.1/4	115	90	15	M12	4	135	100	19	M16	4	135	100	19	M16	4	135	100	19	M16	4	135	100	19	M16	4
40	1.1/2	120	95	15	M12	4	140	105	19	M16	4	140	105	19	M16	4	140	105	19	M16	4	140	105	19	M16	4
50	2	130	105	15	M12	4	155	120	19	M16	4	155	120	19	M16	8	155	120	19	M16	8	155	120	19	M16	8
65	1.1/2	155	130	15	M12	4	175	140	19	M16	4	175	140	19	M16	8	175	140	19	M16	8	175	140	19	M16	8
80	3	180	145	19	M16	4	185	150	19	M16	8	200	160	23	M20	8	200	160	23	M20	8	200	160	23	M20	8
100	4	200	165	19	M16	8	210	175	19	M16	8	225	185	23	M20	8	225	185	23	M20	8	225	185	23	M20	8
125	5	235	200	19	M16	8	250	210	23	M20	8	270	225	25	M22	8	270	225	25	M22	8	270	225	25	M22	8
150	6	265	230	19	M16	8	280	240	23	M20	8	305	260	25	M22	12	305	260	25	M22	12	305	260	25	M22	12
200	8	320	280	23	M20	8	330	290	23	M20	12	350	305	25	M22	12	350	305	25	M22	12	350	305	25	M22	12
250	10	385	345	23	M20	12	400	355	25	M22	12	430	380	27	M24	12	430	380	27	M24	12	430	380	27	M24	12
300	12	430	390	23	M20	12	445	400	25	M22	16	480	430	27	M24	16	480	430	27	M24	16	480	430	27	M24	16
350	14	480	435	25	M22	12	490	445	25	M22	16	540	480	33	M30x3	16	540	480	33	M30x3	16	540	480	33	M30x3	16
400	16	540	495	25	M22	16	560	510	27	M24	16	605	540	33	M30x3	16	605	540	33	M30x3	16	605	540	33	M30x3	16
450	18	605	555	25	M22	16	620	565	27	M24	20	675	605	33	M30x3	20	675	605	33	M30x3	20	675	605	33	M30x3	20
500	20	655	605	25	M22	20	675	620	27	M24	20	730	660	33	M30x3	20	730	660	33	M30x3	20	730	660	33	M30x3	20
550	22	720	665	27	M24	20	745	680	33	M30	20	795	720	39	M36x3	20	795	720	39	M36x3	20	795	720	39	M36x3	20
600	24	770	715	27	M24	20	795	730	33	M30	24	845	770	39	M36x3	24	845	770	39	M36x3	24	845	770	39	M36x3	24
650	26	825	770	27	M24	24	845	780	33	M30	24	895	820	39	M36x3	24	895	820	39	M36x3	24	945	850	48	M45x3	24
700	28	875	820	27	M24	24	905	840	33	M30	24	960	875	42	M39x3	24	960	875	42	M39x3	24	995	900	48	M45x3	24
750	30	945	880	33	M30	24	970	900	33	M30	24	1020	935	42	M39x3	24	1020	935	42	M39x3	24	1080	970	56	M52x3	24
800	32	995	930	33	M30	24	1020	950	33	M30	28	1085	990	48	M45x3	24	1085	990	48	M45x3	24	1140	1030	56	M52x3	24
900	36	1095	1030	33	M30	24	1120	1050	33	M30	28	1185	1090	48	M45x3	28	1185	1090	48	M45x3	28	1250	1140	56	M52x3	28
1000	40	1195	1130	33	M30	28	1235	1160	39	M36	28	1320	1210	56	M52x3	28										
1100	44	1305	1240	33	M30	28	1345	1270	39	M36	28	1420	1310	56	M52x3	32										
1200	48	1420	1350	33	M30	32	1465	1380	39	M36	32	1530	1420	56	M52x3	32										
1400	56											1755	1640	62	M52x3	36										

D = Flange diameter  
 n = Number of bolt holes  
 Hcd = Hole circle diameter  
 d = Diameter of bolt holes

# FLANGE DIMENSIONS - ANSI

DN	INCH	ANSI CLASS 150					ANSI CLASS 300						
		D	Hcd	d	BOLT	n	D	Hcd	d	BOLT	n		
		inch					inch						
25	1"	108	80	16	1/2"	4	124	89	20	5/8"	4		
32	1.1/4"	118	89	16	1/2"	4	133	98	20	5/8"	4		
40	1.1/2"	127	98	16	1/2"	4	156	114	23	3/4"	4		
50	2"	152	121	20	5/8"	4	165	127	20	5/8"	8		
65	1.1/2"	178	140	20	5/8"	4	190	149	23	3/4"	8		
80	3"	190	152	20	5/8"	4	210	168	23	3/4"	8		
100	4"	229	190	20	5/8"	8	254	200	23	3/4"	8		
125	5"	254	216	23	3/4"	8	279	235	23	3/4"	8		
150	6"	279	241	23	3/4"	8	318	270	23	3/4"	12		
200	8"	343	298	23	3/4"	8	381	330	23	7/8"	12		
250	10"	406	362	26	7/8"	12	445	387	32	1"	16		
300	12"	483	431	26	7/8"	12	520	450	35	1.1/8"	16		
350	14"	533	476	28	1"	12	584	514	35	1.1/8"	20		
400	16"	597	540	29	1"	16	648	571	38	1.1/4"	20		
450	18"	635	578	32	1.1/8"	16	710	629	35	1.1/4"	24		
500	20"	698	635	32	1.1/8"	20	775	685	38	1.1/4"	24		
600	24"	813	749	35	1.1/4"	20	915	813	42	1.1/2"	24		
700	28"	927	864	35	1.1/4"	28	1035	940	45	1.1/2"	28		
750	30"	984	914	35	1.1/4"	28	1098	997	48	1.3/4"	28		
800	32"	1060	978	41	1.1/2"	28	1149	1054	51	1.3/4"	28		
900	36"	1168	1086	41	1.1/2"	32	1270	1168	54	2"	32		
1000	40"	1289	1200	41	1.1/2"	36							
1100	44"	1403	1314	41	1.1/2"	40							
1200	48"	1511	1422	41	1.1/2"	44							

D = Flange diameter  
 n = Number of bolt holes  
 Hcd = Hole circle diameter  
 d = Diameter of bolt holes

# HOW TO MEASURE A VALVE

In order to supply correct valve we want information about dimensions acc to below.  
If possible also medium, pressure and temperature.

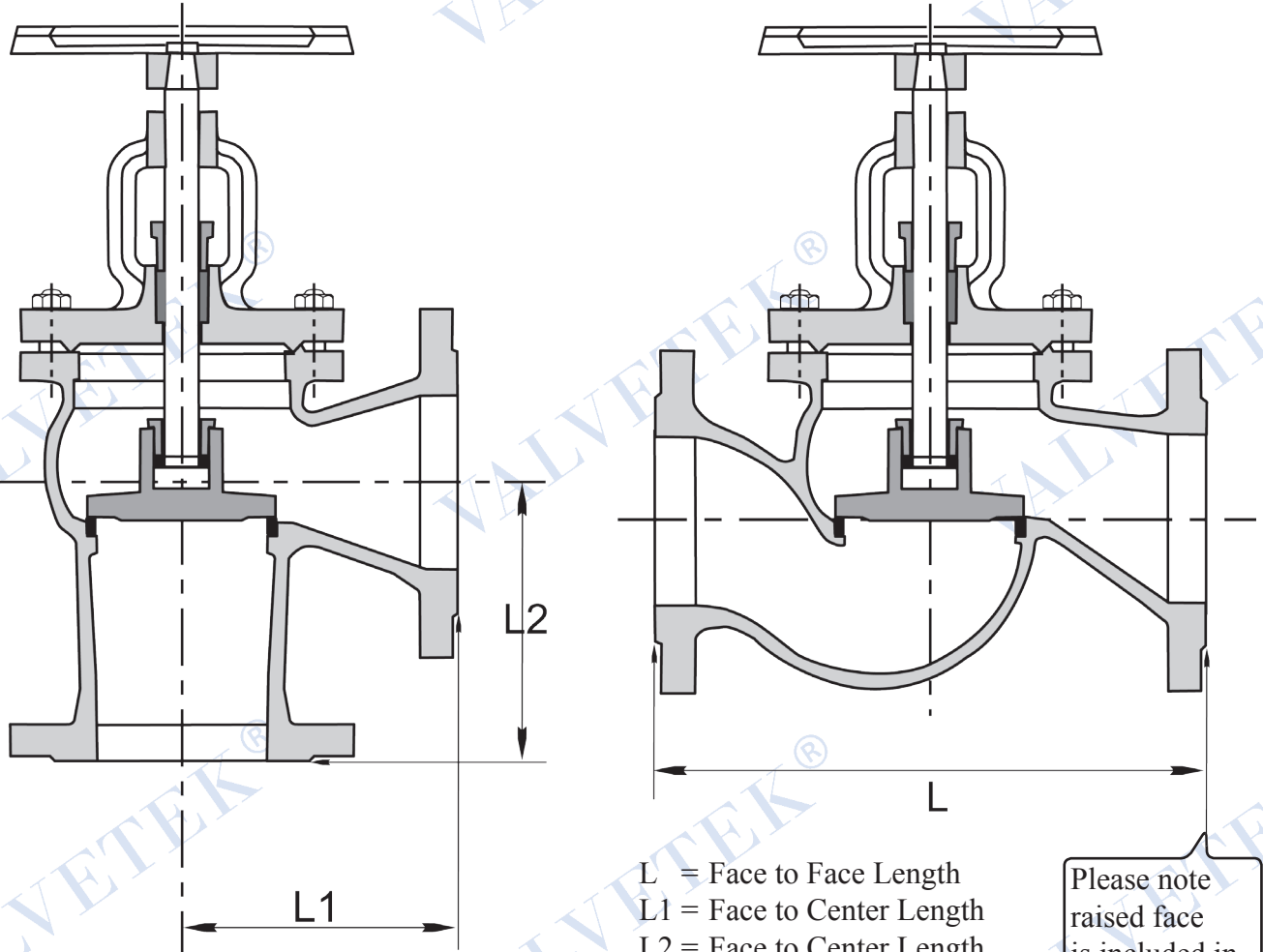

$L$  = Face to Face Length  
 $L1$  = Face to Center Length  
 $L2$  = Face to Center Length

Please note raised face is included in  $L$ ,  $L1$  and  $L2$

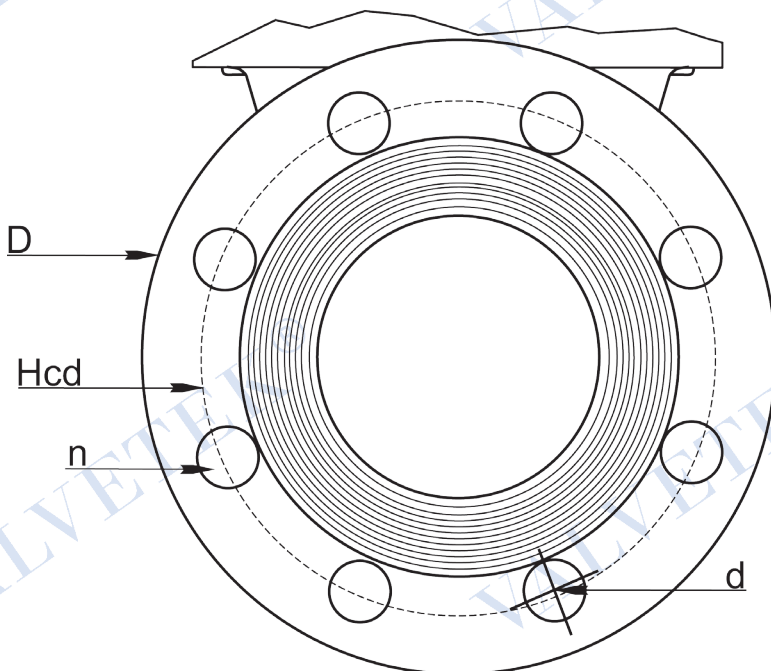

$D$  = Flange diameter  
 $n$  = Number of bolt holes  
 $Hcd$  = Hole circle diameter  
 $d$  = Diameter of bolt holes

## SEAT MATERIALS

Name		Temp. °C	Suitable For
Buna-N NBR, Nitril	<b>NBR</b>	-30° +90°	Oils, fats & Fuels (not gasoline)
EPDM	<b>EPDM</b>	-50° +130°	General purpose, highly-resistant to temperatures most corrosive chemicals and abrasive liquids
VITON	<b>FPM</b>	-40° +200°	Concentrated sulphuric & other acids, aromatic hydrocarbons, chlorine services.
PTFE +25% Glass	<b>PTFE</b>	-50° +210°	General purpose, highly-resistant to temperatures most corrosive chemicals.
PTFE +50% St. steel-Aisi-316	<b>PTFE/S</b>	-50° +230°	
SILICONE	<b>VSI</b>	-50° +130°	Moderate or oxidizing chemicals, ozone, concentrated sodium hydroxide. Recommended for food.
Natural rubber	<b>NR</b>	-50° +130°	General purpose, abrasives, water, dilute mineral acids.